

## Chamber Theatre

Lower Ground Floor



This theatre space is suited to meetings, seminars, breakouts from conferences, and performances. The space seats around 120 people (layout dependent) on 3 rows of rake. There is limited natural light, with blackout available for performances. There is sound breakout from and into the adjoining Studio. There is also an underground railway which is occasionally audible in this space. This space does not have its own lantern stock or control gear, but this may usually be borrowed from the Main Space. This space has a pair of 32A SP points, a 32A TP point, and some 13A sockets available for power, and the fixed grid is at approximately 3.5M. For further details download Chamber Theatre on the left.

Click on the floorplan below for an enlargement or download the high resolution PDF using the link to the left.

### Testimonials:

“Great! Very helpful staff”. Niraj Gohel, ROOT.

“I would definitely consider the Black-E for future events. Also would recommend to others from my experiences of hiring”. Rebecca Little, John Moores University, Art and Design Academy.

“The Black-e staff were very accommodating and nothing was too much trouble”. Amy Burn, events coordinator, Down Syndrome Liverpool.

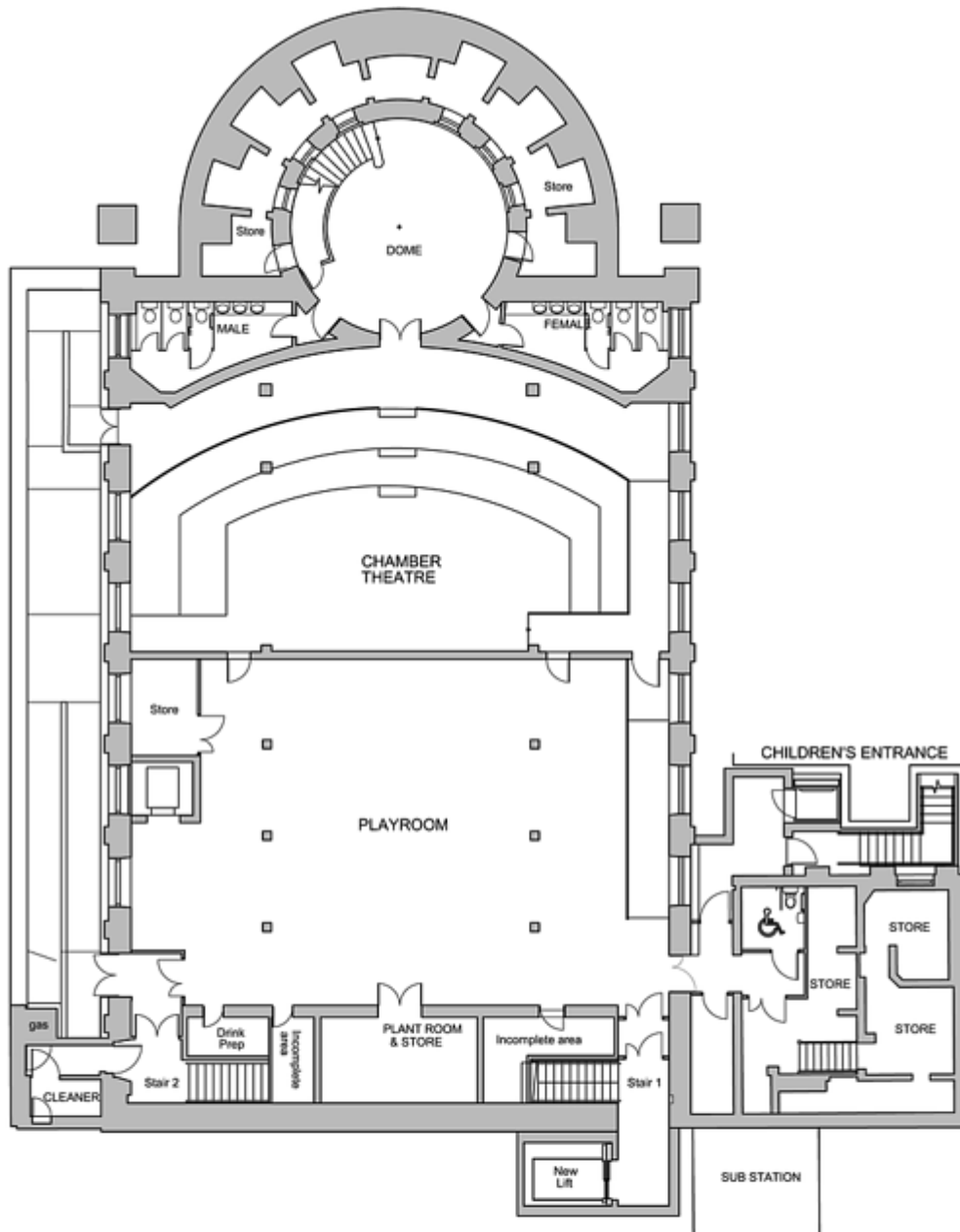

# LOWER GROUND FLOOR



contract  
THE BLACKIE

drawing  
LOWER GROUND FLOOR

dwg no.  
3389 SK200

scale  
1:200

Source URL: <https://theblack-e.co.uk/content/rentals/chamber-theatre>