

Studio

Lower Ground Floor

This space has a flat wooden floor, and is suited to rehearsal and workshop use as well as to meetings, seminars, and breakouts from conferences. The space can also be adapted for performances which require a larger stage area than available in the Chamber Theatre, when seating for around 120 people (layout dependent) can be accommodated. The space can also be adapted to include stalls for fairs. There is limited natural light, with blackout available when required. There is sound breakout from and into the adjoining Chamber Theatre.



There are two 32A SP power points available in addition to some 13A power points. For further details download Studio on the left.

Click on the floorplan below for an enlargement or download the high resolution PDF using the link to the left.

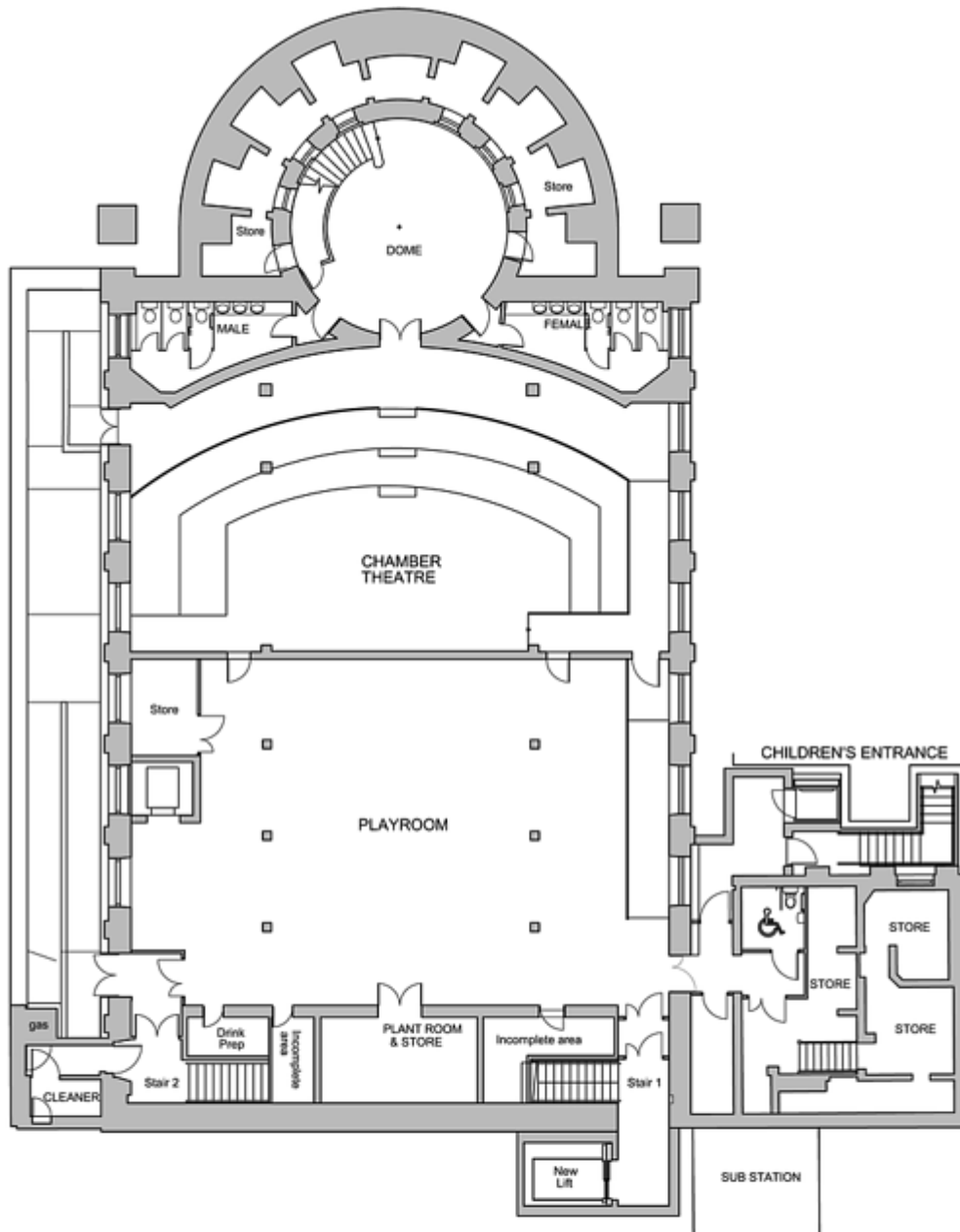

LOWER GROUND FLOOR



contract
THE BLACKIE

drawing
LOWER GROUND FLOOR

dwg no.
3389 SK200

scale
1:200

Source URL: <https://theblack-e.co.uk/content/rentals/studio>